

**HARTWELL**

**Neighborhood Business District**

**Urban  
Design  
Plan**

February 1981



**Pflum,  
Klausmeier & Wagner**  
Consultants

HARTWELL  
NEIGHBORHOOD BUSINESS DISTRICT

URBAN DESIGN PLAN

FEBRUARY 1981

Prepared By  
Pflum, Klausmeier & Wagner Consultants  
424 East Fourth Street  
Cincinnati, Ohio 45202

## TABLE OF CONTENTS

	PAGE
INTRODUCTION . . . . .	1
THE HARTWELL NEIGHBORHOOD BUSINESS DISTRICT . . . . .	4
IMPACT ASSESSMENT AREAS . . . . .	6
HARTWELL ECONOMIC CONDITION AND FUTURE DIRECTION . . . . .	8
HARTWELL NEIGHBORHOOD BUSINESS DISTRICT URBAN DESIGN PLAN . . .	13
URBAN DESIGN CONCEPT . . . . .	13
URBAN DESIGN CONCEPT OBJECTIVES . . . . .	13
URBAN DESIGN PLAN . . . . .	16
NORTHERN CORE AREA . . . . .	17
SOUTHERN CORE AREA . . . . .	22
CENTRAL CORE AREA . . . . .	27
DOMINANT ELEMENTS OF THE URBAN DESIGN PLAN . . . . .	29
RECOMMENDED MAJOR CHANGES . . . . .	31
CIRCULATION POLICIES - VEHICULAR . . . . .	33
CIRCULATION POLICIES - PEDESTRIAN . . . . .	35
PARKING . . . . .	37
URBAN ENVIRONMENTAL QUALITY . . . . .	38
IMPLEMENTATION AND PROGRAM SCHEDULE . . . . .	45
PHASING . . . . .	46

	PAGE
URBAN DESIGN REGULATORY REQUIREMENTS . . . . .	52
LEGAL BASIS FOR PROPERTY ACQUISITION . . . . .	53
HARTWELL NBD BOUNDARY DESCRIPTION (MUNICIPAL PORTION ONLY) . .	55

## LIST OF FIGURES

FIGURE		PAGE
1	NBD STUDY AREA BOUNDARY . . . . .	5
2	IMPACT ASSESSMENT AREAS . . . . .	7
3	ECONOMIC/COMMUNITY BASE: URBAN DESIGN CONCEPT . . . . .	12
4	NBD URBAN DESIGN SUBAREAS . . . . .	15
5	HARTWELL NBD URBAN DESIGN PLAN . . . . .	18
6	SOUTHERN CORE AREA . . . . .	23
7	CENTRAL CORE AREA: CONCEPT SKETCH OF INTENSIVE RE-USE . . . . .	30

## LIST OF TABLES

TABLE		PAGE
1	HARTWELL NBD URBAN DESIGN IMPLEMENTATION PROGRAM: Implementation Grants and Actions . . . . .	47
2	HARTWELL NBD URBAN DESIGN IMPLEMENTATION PROGRAM: Phasing of Grants and Actions . . . . .	49

## INTRODUCTION

The purpose of this report is to present and describe the Urban Design Plan for the Hartwell Neighborhood Business District (NBD). The impending plans of the Kroger Company to build a new superstore in Hartwell has necessitated a re-evaluation and redesign of the recently proposed preliminary 1980 Urban Design Plan for the Hartwell Business District, with one issue being that of the potential impact of the planned superstore on the Hartwell NBD. This Urban Design Plan is recommended in consideration of the opportunities and constraints that will emerge; assessment of the consequences and redefinition of the new role of the Hartwell NBD; and in realization of the need to articulate the growth potential with respect to land use redevelopment, development, and implementation mechanisms.

From the outset, it is important to emphasize that the planned Kroger Company superstore or another use of similar caliber is a given variable with respect to the analysis, evaluation, and formulation of the Urban Design Plan. Therefore, recommendations with respect to the decision for locating or not locating such a facility in the designated site are beyond the scope of the Study and Urban Design Plan.

The planned relocation of the Kroger grocery store from its present location just north of Compton to a new site at Shadybrook and Vine Street represents more than merely moving 2,000 feet south, down Vine Street. For one thing, the shift represents a doubling of Kroger's facility size, while greatly expanding its merchandise line.

At one level of consideration, the Kroger move represents the equivalent of adding a second Kroger store to the Hartwell Business District. At a second level, the relocation represents shifting a large segment of the grocery business away from the northern section to the southern sector of the Hartwell business district.

The impact of this shift is expected to cause some movement of change in the physical and economic make-up of the entire business district. While such a possibility and potential were not a reality during the preparation of the earlier proposed Urban Design Plan for the Hartwell NBD, the present Urban Design Plan and recommendations have been developed by considering as their key determinant this emerging potential for economic and community development. In addition, this new potential sets forth the debating point for the re-definition of Hartwell and the establishment of a new and expanded role in the Cincinnati area. Unlike most business districts in Cincinnati where urban design plans define and set boundaries between the business and residential environments and, therefore, internalizing development and redevelopment activities, this emerging role of the Hartwell NBD provides opportunities for growth and appropriate expansion within the established business and community boundaries.

Specifically, with respect to the impact of the proposed facility, the Urban Design Plan addresses the following:

- defines the types of retail use changes that the planned facility will set in motion;
- proposes a development and reinvestment strategy that can best maximize the beneficial aspect of such changes;
- provides a set of regulatory and design measures for mitigating negative consequences of the impact with respect to vehicular and pedestrian traffic, functional and aesthetic land use compatibilities, streetscape visual quality and maintenance of a desired livability level;
- sets forth an incremental development process to serve as a framework for decision-making by local businesses and the City of Cincinnati;
- establishes a physical framework for development and re-development to be used in concert with the incremental public and private decisions;
- establishes a basis for ongoing maintenance of new improvements by the private sector; and
- establishes a basis for private funding participation in support of improvements and revitalization activities.



## THE HARTWELL NEIGHBORHOOD BUSINESS DISTRICT

The Hartwell Neighborhood Business District comprises a relatively narrow strip of land located on both sides of Vine Street extending north from the B & O Railroad overpass to Hillsdale (Figure 1). Approximately half of the business district is located in Hamilton County outside the City of Cincinnati's jurisdiction. The City's corporation line runs down the center of Vine Street, therefore, the west side of Vine is in Springfield Township, while the east side of the street lies within the City. The only exception is the Hartwell Playground which is located on the west side of Vine below West Galbraith Road, which lies within the City of Cincinnati's corporation limits.

For planning and economic development purposes, the business district is treated as a unified whole, irrespective of the jurisdictional dichotomy of the district. The Urban Design Plan, therefore, includes both sides of Vine Street, recognizing, however, that the City of Cincinnati can adopt policies and plans affecting only that portion of the business district which lies within its political jurisdiction. The Plan and its implementation strategy, therefore, includes separate program policies for both jurisdictions. Consequently, the adoption and implementation of the Urban Design Plan can begin independently of a formal response from the governments of Hamilton County and Springfield Township. Yet, the Design Plan strongly recommends the initiation and establishment of a partnership between the City and the other two levels of government in order to capitalize on the mutually beneficial economic and community development opportunities.

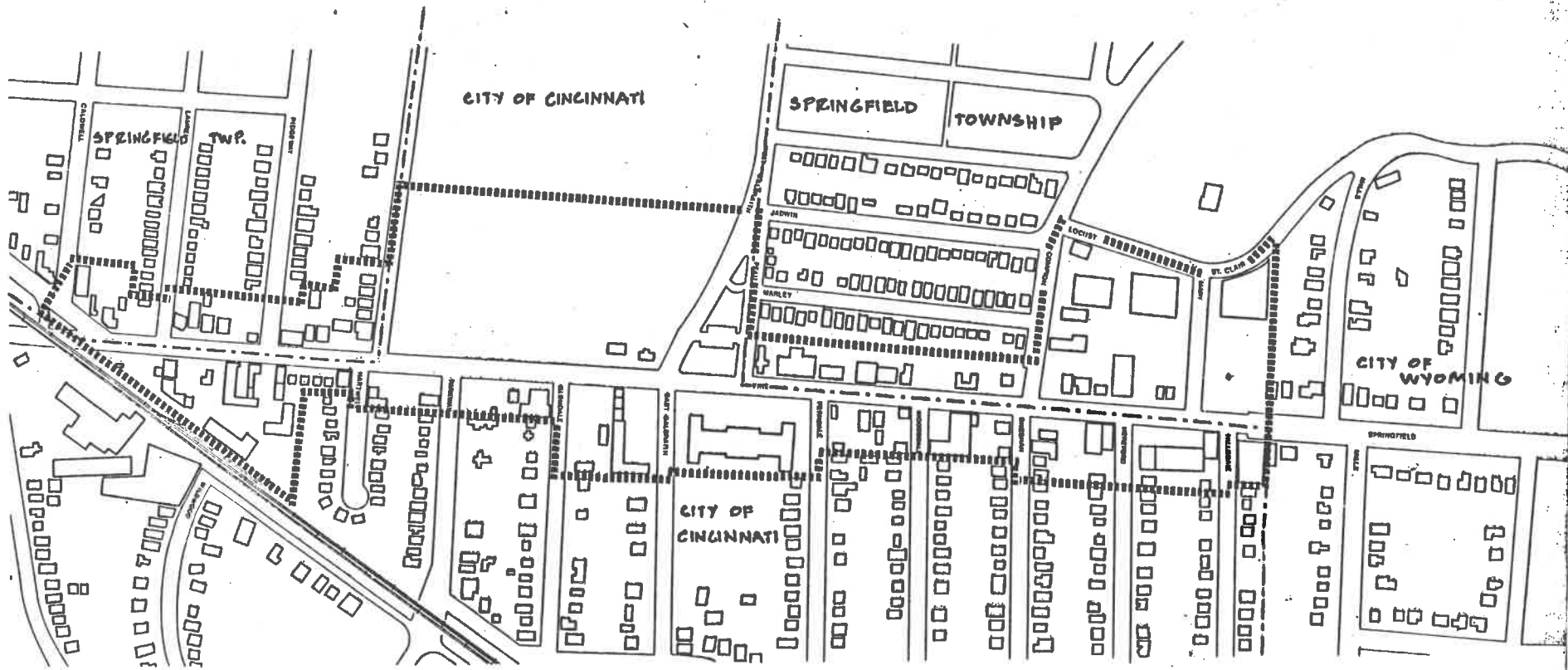

1

**NBD STUDY AREA BOUNDARY**

1" = 500' APPROX.

NORTH 

**Hartwell Neighborhood Business District Urban Design Plan**

 **Pflum, Klausmeyer & Wagner Consultants**  
414 EAST FOLEY BLVD. #1111 CINCINNATI, OH 45218 1010-731-4477

The northern section of the Vine Street business district is the principal area of the district's retail activities. The southern portion of the commercial district, on the other hand, comprises a compilation of uses consisting primarily of used car lots, automobile service garages and repair shops, intermingled with retail, residential, and light industrial uses.

This southern section of the business district is substantially blighted. Revitalization of this area was not a viable option for the City to pursue prior to the possibility of a new Kroger superstore being developed there. Because of economic and environmental reasons, the earlier urban design concept attempted to direct and focus public and private revitalization efforts to the northern sector of the NBD. This original design concept merely recognized the extreme costs and difficulty that would be required to undertake a revitalization for the total length of the NBD, especially in the blighted southern area of the Hartwell NBD.

#### IMPACT ASSESSMENT AREAS

The existing land use and transportation system in the Hartwell NBD planning area dictate the delineation of three subareas (Figure 2), in order to specifically address development and design issues and recommendations. Later in this report, these three areas are described with respect to their legal boundary and are considered as a whole in forming the Hartwell NBD.

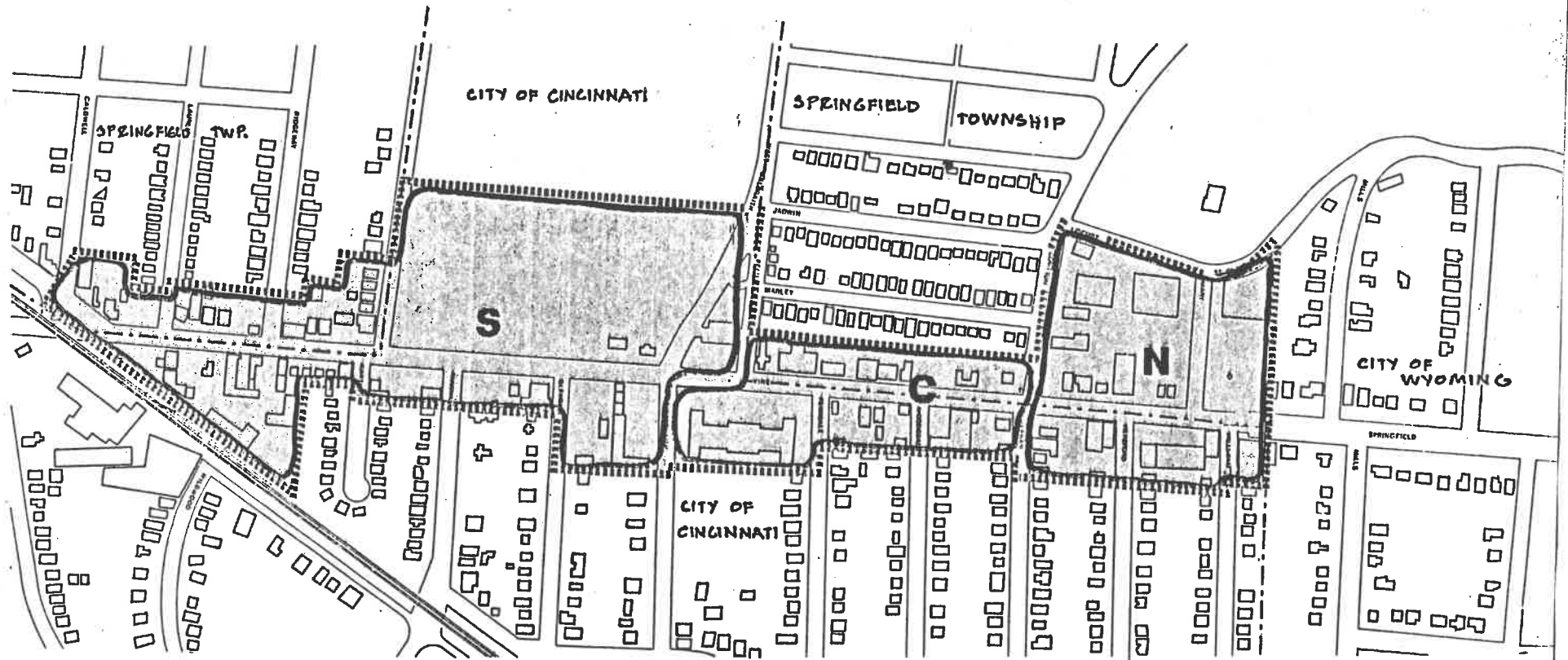

- S** SOUTHERN
- C** CENTRAL
- N** NORTHERN

1"=500' APPROX.



2  
**IMPACT ASSESSMENT AREAS**

**Hartwell Neighborhood Business District Urban Design Plan**

## HARTWELL ECONOMIC CONDITION AND FUTURE DIRECTION

The Hartwell Market area has been shown\* to be quite strong, and is expected to continue to grow in population and purchasing power over the next five years. Market and economic analysis of the business district indicates, however, that the Hartwell Business District has heretofore been unable to capture the full potential of its natural market. Thus far, the Hartwell NBD has failed to generate the volume of sales which the market survey implies should be available to local merchants.

There are several specific factors that have contributed to the poor sales performance of the NBD. First, the NBD lacks an identifiable commercial core. The area north of Compton Road contains the majority of neighborhood retail type uses. However, that area is interrupted by inappropriate uses, such as auto repair shops, and gasoline stations. More importantly, the physical arrangement of buildings and functions are such that pedestrian shoppers cannot easily move from building to building. The inadequacy of parking and the intrusiveness of heavy traffic volumes on Vine Street create an unpleasant shopping environment.

Apart from the physical and environmental deficiencies of the business district, there are also a number of retail gaps and deficiencies that will need to be filled in order for the district to improve its market penetration. There is a need to establish a concentration of retail

---

\*"Hartwell Neighborhood Business District: Economic Base Study", Pflum, Klausmeier & Wagner Consultants, October, 1979

activities sufficient to draw more shoppers to the area. Based upon an economic base study and market analysis of the Hartwell NBD, the following improvements were found to be needed:

- There is a need to diversify the commercial mix of the NBD Core, to include convenient and specialty shops.
- There is a need to increase and expand the existing retail space to provide new retail functions.
- There is a need to provide high quality specialty shops and boutique shops to attract the market's higher income residents.
- The whole length of the NBD cannot be considered as a single unified district of like functions.
- There is a need to concentrate similar ancillary uses within relatively well-defined nodes or activity centers.
- The commercial district will need to comprise two major focal points, located at opposite ends of the NBD.

One of the major problems that has long confronted the Hartwell Business District has been the lack of new investment and/or support

for new commercial development relative to the district's market potential. As stated in the preliminary Urban Design Plan, the Hartwell Business District had clearly failed, as a district, to take advantage of the retail market opportunities that exist there. In this respect, the Kroger superstore facility will tend to affirm the potentialities of Hartwell's natural market.

This new economic statement that Kroger's or any other similar retail facility is making at the southern end of the NBD, relative to the economic viability of the Hartwell natural market, should have a positive effect on the commercial vitality of the business district as a whole. It is assumed that major changes generated by the Kroger development will take place in the general area of the new site. However, given the market potential of the business district, the beneficial impact of the Kroger facility, as intended in this Design Plan, attempts to extend the emerging economic development potential to virtually all the district.

Within this emerging economic development potential, the Urban Design Plan establishes a physical framework which is intended to achieve the following:

- Establish two commercial core areas, one at each of the southern and northern NBD areas;

- Each of the commercial core areas to have its unique market orientation;
- Each of the two areas to be compatible with each other, in support of their economic market orientation and not in competition;
- Recognize the establishment of the southern commercial and economic development potential as a catalyst for revitalization of that portion of the Hartwell NBD, which previously was found to be unattainable due to blighting conditions;
- In a similar manner, recognize the establishment of the southern commercial area as a catalyst for the re-definition and redevelopment of the northern core area as a vital neighborhood retail center, thus allowing the northern area to take advantage of this new economic development potential; and
- Allow for the selective re-definition and redevelopment of the strip-retail area between the two commercial core areas to begin to take place within the emerging market dynamics afforded throughout the Hartwell NBD.

Figure 3 shows the conceptual economic base for the formulation of the Urban Design Plan.



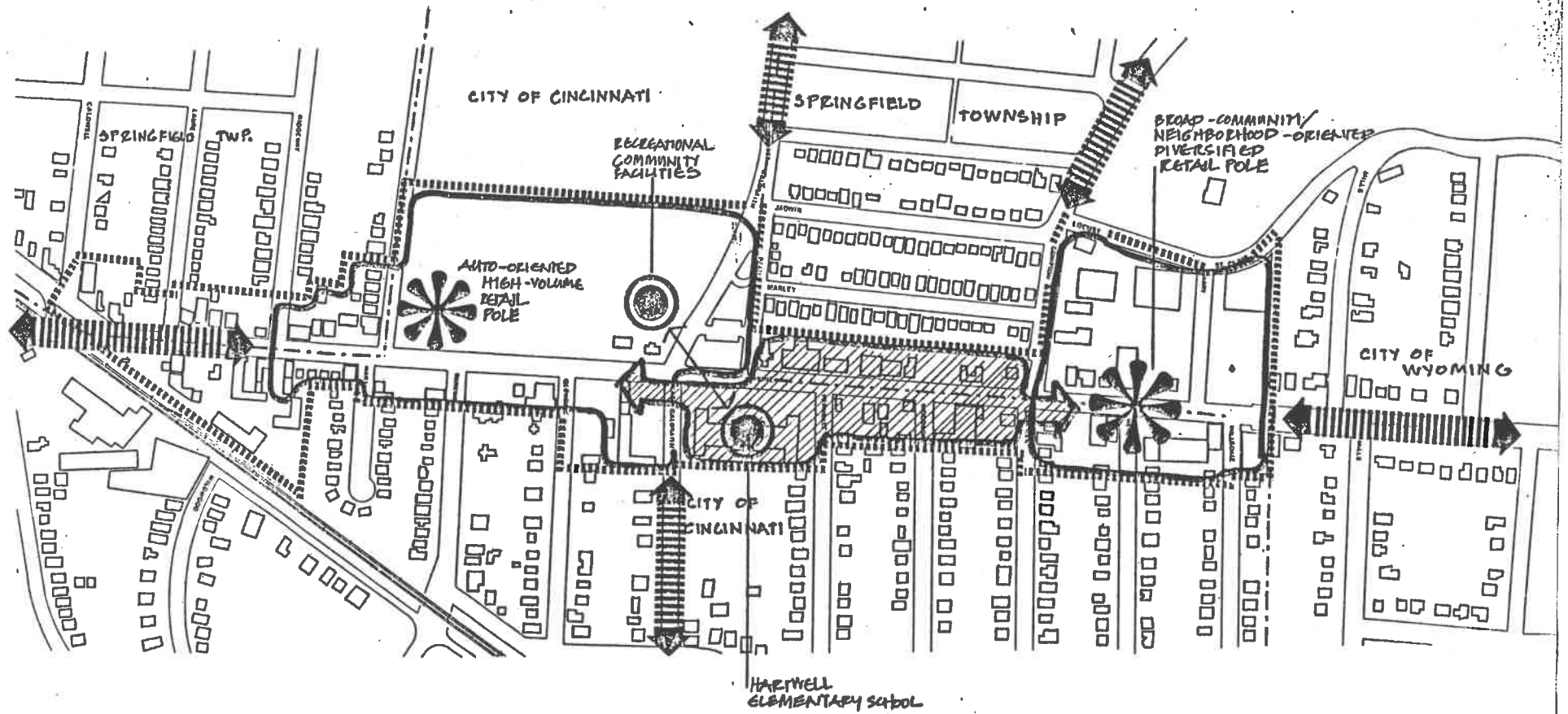

3  
**ECONOMIC/COMMUNITY BASE: URBAN DESIGN CONCEPT**

1" = 500' APPROX

NORTH →

**Hartwell Neighborhood Business District Urban Design Plan**

**Pflum, Klausmeier & Wagner Consultants**  
 484 EAST 74.5TH STREET CINCINNATI, OH 45202 (513) 721-4477

# HARTWELL NEIGHBORHOOD BUSINESS DISTRICT URBAN DESIGN PLAN

## URBAN DESIGN CONCEPT

The essence of the urban design concept is to make the Hartwell Neighborhood Business District an attractive and vital retail environment on both the City and County sides of Vine Street. The Urban Design Concept recognizes as its most basic premise that revitalization of the Hartwell Business District can only be achieved by considering, in a coordinated manner, the redevelopment of commercial property along both sides of Vine Street.

The strongest determinant in giving form to the physical structure of the Plan is the emerging market and economic opportunities. Consequently, the Design Concept is built around the notion of an incremental development process, and recognizes that the economic development opportunities which gradually emerge will require a reorientation in the area's use and development intensity, in order to allow for such opportunities to be captured in the Hartwell NBD. The Urban Design Concept is envisioned to be accomplished through a concentrated development program and process involving the Hartwell Business Community, those investors attracted to the redefined NBD area, the City of Cincinnati, the Hartwell community, and, once formal dialogues have been established, the Hamilton County government.

## URBAN DESIGN CONCEPT OBJECTIVES

1. Maximize the economic investment and redevelopment opportunity that generated the new Kroger superstore.

2. Promote through orderly redevelopment the transformation of lower Vine Street, from used car lots to a new general commercial B-2 retail district keyed to the new Kroger superstore complex. This will require the rezoning of affected property in the City from B-4 to B-2, as well as affected properties in Hamilton County from residential to planned retail zoning.
3. Develop a harmonious neighborhood shopping center within the northern sector of the business district by unifying both physically and functionally the retail uses along both sides of Vine Street between Compton Road and Hillsdale.
4. Utilize an adaptive re-use approach to the redevelopment and revitalization of the business district within the northern retail core.
5. Integrate the business district with the surrounding neighborhood, and limit the business area within the proposed boundaries without further expansion into adjacent residential area, except in extreme cases.
6. Minimize the negative influence that Vine Street exerts on maintaining an automobile-oriented shopping district by strengthening existing opportunities for organized on- and off-street parking.

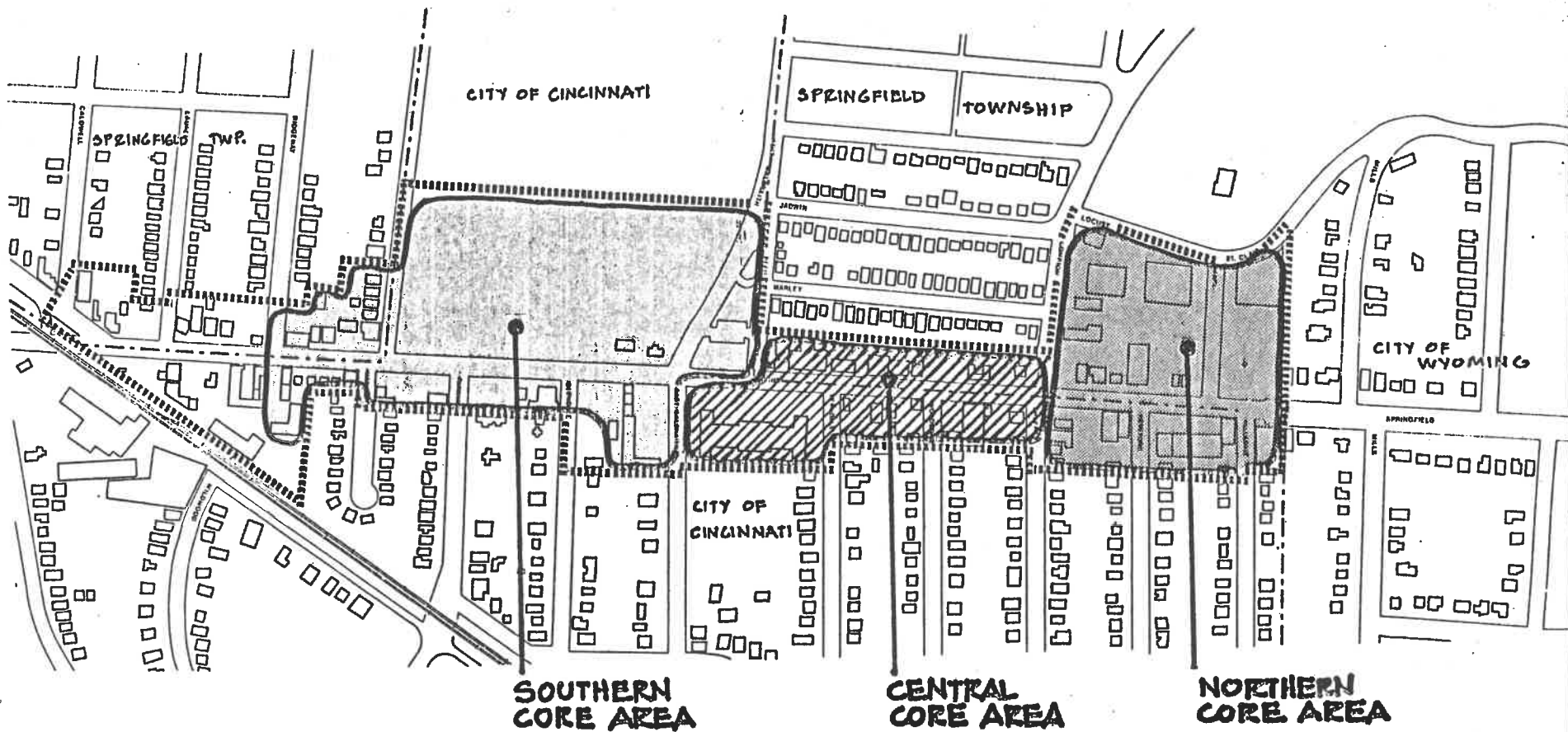

4

# NBD URBAN DESIGN SUB-AREAS

## Hartwell Neighborhood Business District Urban Design Plan

1"=500' APPROX.

NORTH →

**Pflum, Klausmeyer & Wagner Consultants**  
 484 EAST FOURTH STREET CINCINNATI, OHIO 45202 (513) 724-4877

7. Develop a clear physical image which provides for functional cohesiveness in building facades and form, which results in a new retail environment with a strong identity, and pedestrian orientation.
8. Promote supportive office and residential development opportunities in the central core area within a negotiated redevelopment process.

#### URBAN DESIGN PLAN

The Urban Design Plan proposes a comprehensive revitalization strategy for the entire business district. The plan attempts to transform a blighted commercial corridor into a highly visible business district. The principal design strategy of the plan is intended to maximize the full potential of the district's natural retail market, while at the same time, it proposes to take full advantage of the economic reinvestment potential which is being set in motion by the inclusion of a new Kroger superstore in Hartwell.

The Urban Design Plan for the Hartwell Business District extends southward from the Wyoming municipal line at Hillsdale, to the center of the intersection of Vine Street and Ridgeway. The area south of this intersection on the City side of Vine Street is essentially light industrial and automobile repair and is not consistent with the notion of Neighborhood Retail. For this reason, the Urban Design Plan does not include the area south of Ridgeway.

The design plan deals individually with three separate geographic subareas that collectively comprise the NBD. Each subarea is proposed to develop a distinct function division of specialized services. Moreover, each subarea is intended to be mutually compatible within the context of the total business district. The Hartwell NBD Urban Design Plan is shown in Figure 5.

As previously stated, the design framework attempts to create two distinct commercial core areas, located at opposite ends of the business district: A northern core area located between Compton Road and the City of Wyoming and including both sides of Vine Street; and a southern core area located between Galbraith and Ridgeway.

#### NORTHERN CORE AREA

The revitalization strategy for the northern core area is predicated on a need to redirect its commercial orientation from general convenience to higher specialized retail, while increasing its commercial diversity.

The design plan, by restructuring the northern core area's commercial orientation, attempts to create a whole new set of opportunities consistent with its market potential. That is, the plan proposes a development scenario that would internalize the market's externalities, while creating an environmental quality characterized of the Compton/

Galbraith Road area. The plan proposes a neighborhood-oriented diversified retail pole which would include commercial, retail, entertainment, and office uses. Principally, the two major grocery stores located on the west side of Vine Street would be readapted to accommodate small units of specialty retail shops and/or larger commercial units, such as furniture, appliances, hardware-type uses.

The following uses are proposed for the northern core area:

- An entertainment/retail/office zone at the corner of Compton and Vine, including a movie theater, the existing fast-food restaurant, a new coffee/ice cream parlor, the two existing small retail units along Vine Street, and the existing retail/office building;
- Office uses in the existing medical office building;
- The inclusion of the existing community use building;
- A cluster of five new commercial units (approx. 9,500 sq. ft.) along the northern end of the core area;
- The reuse of the presently used by Kroger and Thoroughfare structures into smaller unit retail space and/or such uses as furniture stores, appliances, hardware, etc.

-The expansion of retail space for the Big Melon at the corner of Compton and Vine at the present location of the service station;

-Improvements along the facades and streetscape of Fidelity Shopping and Furniture Store;

-Coordinated parking and circulation plans, as well as emphasis on pedestrian movement and facilities;

-Improvements for sidewalks, building facades, signage, etc.

During the early phases of redevelopment, the Urban Design Plan can be implemented by focusing on the retail uses east of Vine Street; by appropriately reusing the two large buildings through interim changes; by renovating these structures to accommodate smaller shops, and by improving the parking, vehicular/pedestrian circulation and streetscape areas.

Following is a sequence of events with respect to the evolution of the Urban Design Plan in the northern core area (See also the Urban Design Plan - Figure 5).

- A. Urban Design Plan adoption;
- B. Organizational arrangements, roles and responsibilities;





- C. Re-use, redevelopment and improvements of the portion of the area along the eastern side of Vine Street, including the expansion of the Big Melon;
- D. Re-use of the present Kroger store for retail uses (i.e., furniture, appliances, etc.) or via remodeling to smaller units for specialty stores;
- E. Implementation of streetscape improvements along the same eastern side of Vine Street;
- F. Street and traffic engineering improvements at the intersection of Vine and Compton, including pedestrian crossings;
- G. Parking and pedestrian circulation improvements along the same eastern side of Vine Street;
- H. Demolition of marginal use structures for temporary use as parking areas;
- I. Selective parking improvements at the portion west from Vine Street;
- J. Facade improvements and cosmetic treatment of the Drugstore Building, office, and community buildings;
- K. Re-use of the Thoroughfare Store (if necessary) into smaller retail units;
- L. Redevelopment of the portion along the intersection of Compton and Vine for entertainment/retail uses by developing a new structure next to the fast foot restaurant;
- M. Implementation of necessary streetscape, parking, circulation and pedestrian improvements;

- N. Development of the public amenity space along Vine Street.
- O. Development of additional small commercial units at the vicinity of the public space;
- P. Completion of all streetscape improvements.

#### Southern Core Area

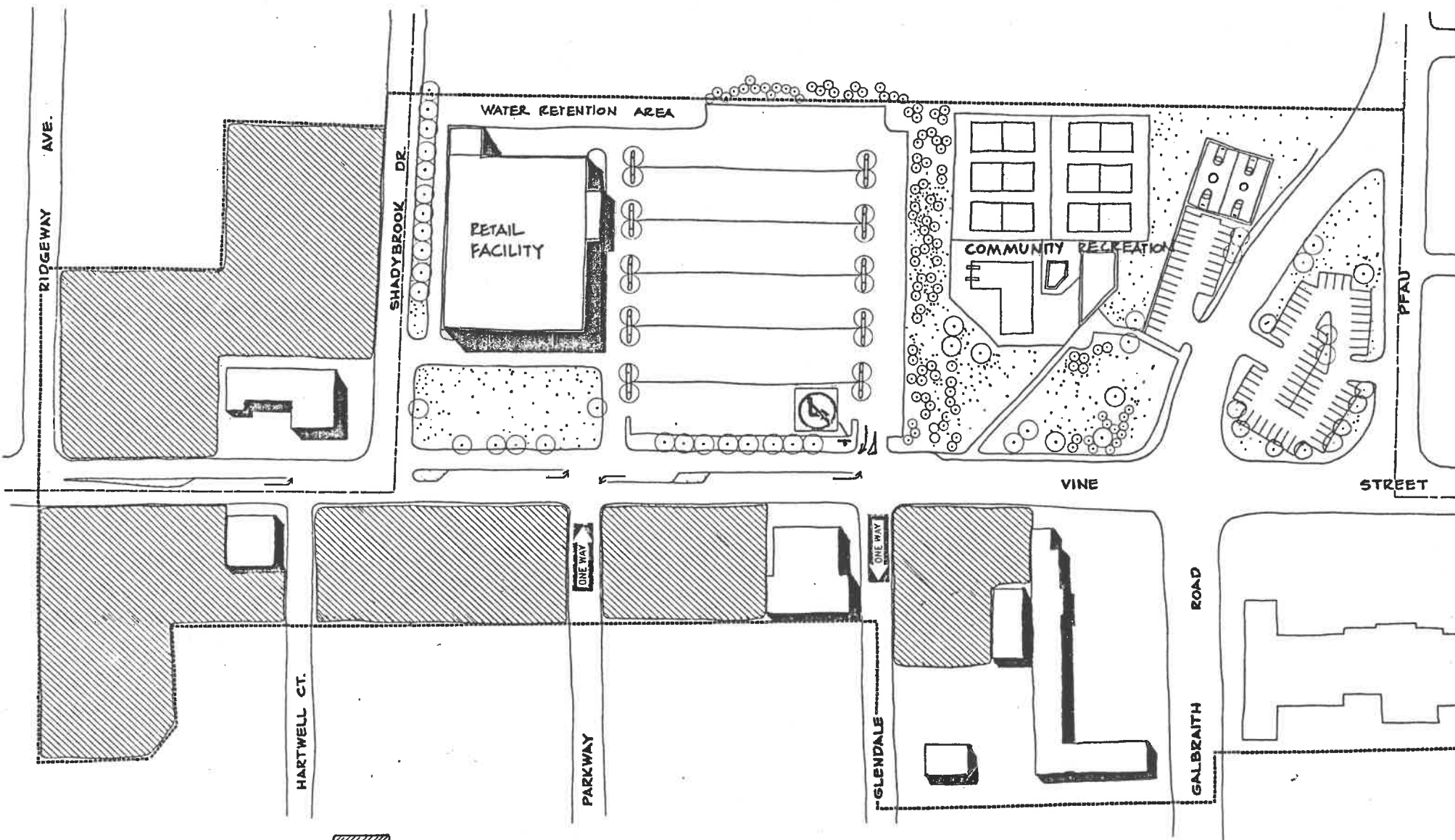
The southern commercial core area centers on Vine Street and Shadybrook and includes the area that has recently been rezoned B-2, general commercial. The rezoned site is expected to be developed by the Kroger Company for a 42,000 square foot "superstore". The development of the Kroger facility would constitute a significant change in the land use and economic investment pattern of the immediate and general area. It is anticipated based on other similar situations, that the superstore facility will generate additional new off-site development activity within the Vine Street corridor. Such development normally tends to be high volume retail and discount stores, banking and savings institutions and fast food restaurants. There are a number of other factors that also influence the development pattern of such an area, including traffic volume, site location and highway access and zoning. However, a superstore facility of the magnitude proposed for the area in question will generate renewed investment interest, particularly within the lower half of the business district.



 PROPOSED AREAS FOR COMMERCIAL DEVELOPMENT AND REDEVELOPMENT

⑥ SOUTHERN CORE AREA  
**Hartwell Neighborhood Business District Urban Design Plan**

 Pflum, Klausmeier & Wagner Consultants  
 1151 AVENUE 118, SUITE 1000 • CHICAGO, IL 60606 • (773) 791-0477



In this respect, the lower portion of the Vine Street corridor has a very real potential for revitalization due to the development of Kroger facility. The design plan shown in Figure 6 proposes the establishment of adequate development and design standards to foster the physical and economic revitalization of lower end of Vine Street, while at the same time preventing that section of Vine Street from becoming a haphazard commercial strip.

The design plan proposes that the east side of Vine Street from Glendale Street south to the point opposite the centerline of the intersection of Vine and Ridgeway, be down zoned from B-4 to B-2, in order to control the redevelopment of the area as specifically indicated on the design plan.

It is recommended that an Interim Development Control (IDC) District be imposed on the City portion of the NBD, while specific design standards are being formulated as part of an overlay environmental quality district to be imposed later. The Design Plan proposes that specific development controls be developed for each sector of the NBD, as opposed to developing a single set of controls for the NBD as a whole.

The present zoning of the lower sector of the NBD is zoned B-4, Heavy Commercial.

It is recommended that the development standards for the E.Q.D. are designed to foster the commercial redevelopment of the Southern core

area and that such development is of a nature that will not generally compete with the Northern core area. The development and design standards should encourage high volume discount-type stores, including home furnishings, hardware, appliances, gardening, auto parts, paint stores, and the like. The design standards should also establish necessary guidelines for site design layout relative to the design character of the southern core area. Such standards should encourage the redevelopment of large areas, comprising a block face at a time, as opposed to a lot-by-lot redevelopment process. The E.Q.D. should have sufficient flexibility in establishing a commercial mix of uses with adequate development controls and density design standards. Such standards should, for example, determine not only the type but the number of uses permitted within each segment of the business district. Both sides of Vine Street i.e., the County side as well as the City side, should be rezoned for B-2 type uses. The establishment of B-2 type uses will also aid in maintaining a relative degree of compatibility between retail uses and the surrounding community. Opposite the Kroger store across Shadybrook, the plan recommends that should this area be redeveloped for uses other than residential development, such development should be a commercial Planned Unit Development (PUD) for similar uses cited above.

In tandem with the redevelopment of the southern half of the business district, the plan proposes the following specific guidelines applicable to both sides of Vine Street:

- landscaping between building and off-street parking should be part of the amenity package of each site development scheme;
- landscaping, and the planting of trees, should be encouraged both within the public sidewalk right-of-way, as well as along the side and rear boundary lines of the business district;
- adequate landscape screens should be created between and along the district boundary to minimize disruption to adjoining residences;
- all parking areas should have a permanent hard surface and should be adequately laid out and marked;
- parking areas with more than 15 spaces should provide landscaped islands, of five feet in width; and to be planted with durable types of trees of not less than 2 inch caliber;
- common parking areas should be encouraged and consolidated where appropriate;
- individual buildings should be designed and arranged in a manner complimentary with its surroundings, existing or

-proposed, and should minimize its position relative to parking and vehicular circulation and access; and

-the design character of new and/or existing buildings should attempt to improve and upgrade the visual and business image of the area.

### Central Core Area

The central Vine Street core area lies between Sheehan and Compton and Galbraith along both sides of Vine Street. This section of the central business district has been the weakest part of the northern core area section of the neighborhood business district. The total area is approximately three blocks in length. The Hartwell Elementary School, however, consumes one block, leaving the City side of Vine Street with two commercial block faces. The major issues that have confronted this particular section of Vine Street have been inadequate parking, the shallowness of commercial lots, particularly on the County side, the problem of vehicular parking access to specific buildings. The area generally characterizes an obsolete roadway oriented commercial strip. Obsolescences of the area consist basically of two types. First, it is obsolescent in terms of the type and character of many of its buildings, including disinvestment; and second, it is obsolescent in terms of the character of the area relative to increased traffic volumes on Vine Street. Many of the

buildings and functions within this section of Vine Street are out of sink with area changes, and represent a different period, which is becoming increasingly disfunctional as a business area. The area represents a very weak transitional district, where there has been some changes toward more conventional strip commercial. So far, the process has been marginal and somewhat chaotic.

The urban design plan shows the recommended improvements for the central core area with respect to streetscape, curb cuts, and coordinated parking access, as well as the development of additional parking. The plan assumes that the use of the buildings in this area will be determined through the market forces as it will be regulated under the existing zoning regulations.

Further, the urban design plan proposes that this section of the Hartwell NBD has the potential to be considered as a negotiated reinvestment area (NRA) in particular towards the later phases of the plan's implementation. An NRA is an area which has redevelopment potential but whose development configuration cannot be formulated under current conditions. NRA's are designed as "holding pens" awaiting developmental inertia; however, development acceptable for an NRA will be tightly controlled and will conform with rigorous performance standards. NRA's, therefore, discourage random or ad hoc parcel by parcel developments. Each NRA, when developed in accordance with these design standards, will complement the overall urban design redevelopment scheme. Given



an increase in the area's attractiveness to development, a potential concept of a physical configuration of this section of the NBD under a NRA approach is sketched out and shown in Figure 7. The sketch shows that an intensive reuse of the area could accommodate two new condominium housing complexes with controlled access, separated by the street via an aesthetically pleasing brick wall/planting buffer. In addition, the area could accommodate three new office buildings appropriately landscaped with controlled access points.

The urban design plan recognizes that, while an intensive reuse of the central core area could become a reality, present development opportunities and constraints dictate a scaled-down approach to the improvements in this section of the NBD. Therefore, the recommended improvements for the central core area as they are proposed in the overall urban design plan are shown in Figure 5, with the possibility of an intensive reuse as shown in Figure 7 being only a concept for consideration during the plan implementation.

#### DOMINANT ELEMENTS OF THE URBAN DESIGN PLAN

The following are the dominant elements of the Design Plan for all three areas:

- Recommends the establishment of two major commercial retail centers, located opposite each other at either end of the Vine Street Business District.

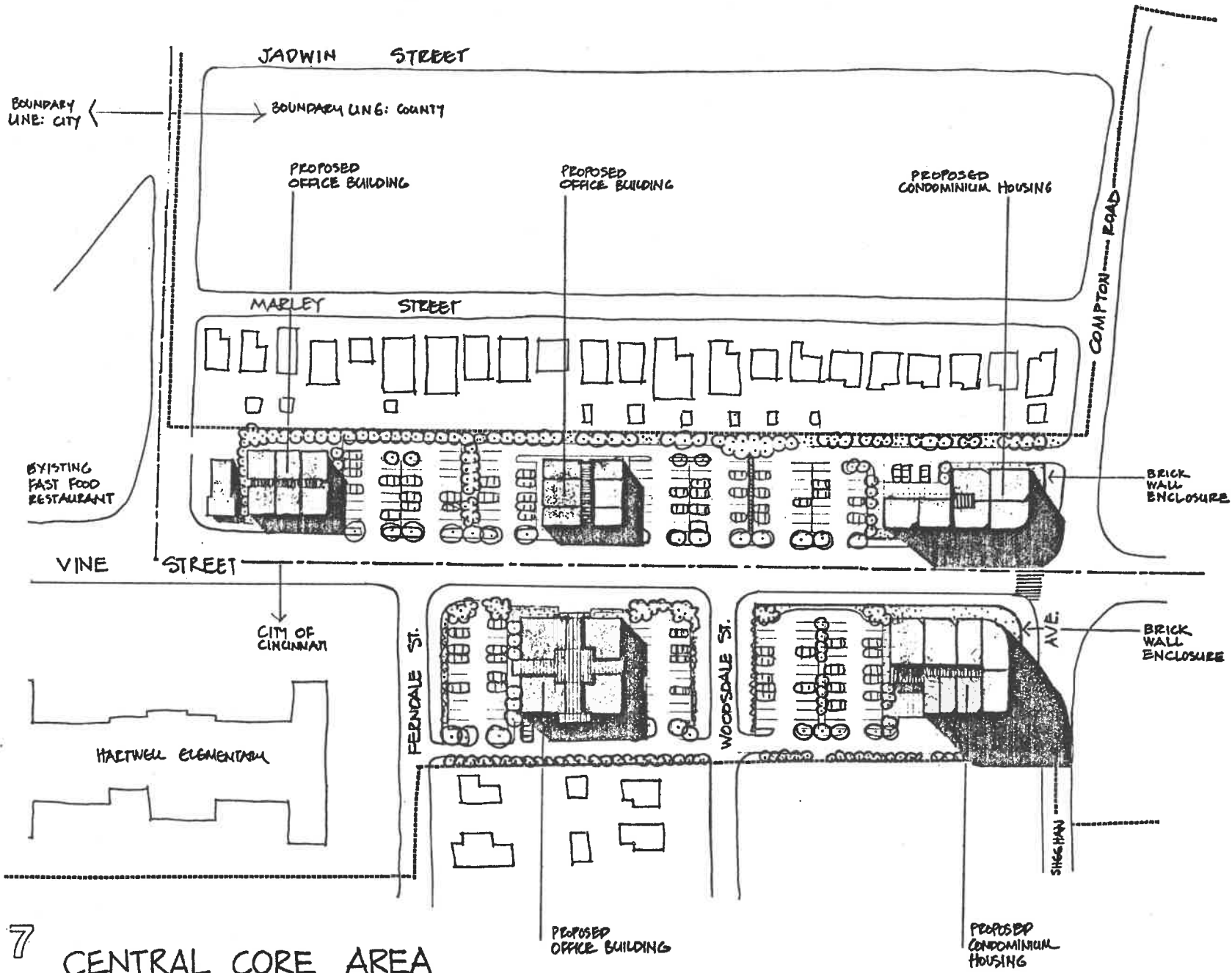

7 CENTRAL CORE AREA  
**Hartwell Neighborhood Business District Urban Design Plan**

**Pflum, Klausmeier & Wagner Consultants**  
 421 EAST FOL, 5TH STREET CINCINNATI, OHIO 45202 (513) 721-4477



- Propose a division of specialization, relative to each commercial center.
- Proposes the redevelopment and revitalization of the Vine Street commercial corridor from Ridgeway north to the City of Wyoming.
- Proposes the development of a unified streetscape design program throughout the Business District.
- Recommends improved vehicular circulation via proposed roadway widening for turning movements and storage lanes for Vine Street and improved parking and driveway access.
- Proposes improved pedestrian circulation, via upgraded sidewalks and crosswalks, and expanded internal pedestrian circulation systems.
- Recommends the elimination of marginal and blighting features of the physical environment.

#### RECOMMENDED MAJOR CHANGES

The Urban Design Plan proposes that certain changes need to occur in the Hartwell Business District:

1. The closing of Mary Street and utilization of this public right-of-way for additional new retail development.
2. The redevelopment of the property at the corner of Locust Street and Compton Avenue for a parking facility to primarily serve the Northern Core Area retail uses.
3. The redevelopment of the property that occupies the northeast quadrant of Sheehan and Vine Street for realigning the Sheehan/Compton Road intersection, and for new commercial expansion.
4. Reorganization of existing parking areas to serve specific subareas within each shopping core area.
5. Redevelopment of the northern core area, between Burger Chef and existing Mary Street, for new commercial/entertainment development.
6. The demolition of the property at 8401-8419 Vine Street for redevelopment as a parking facility.
7. Elimination of all present storefront parking which requires backing onto Vine Street.

8. Roadway widening and improvements made to Locust and Compton Roads.
9. Roadway widening of Vine Street for left turn lanes as indicated on the Urban Design Plan.
10. The designation of Glendale Street as one-way heading east and the designation of Parkway Avenue as one-way heading west. As an alternative option, both streets would become cul-de-sacs where they intersect with Vine Street.
11. Extending Burns Street northward to connect Ridgeway with Shadybrook.
12. Redevelopment of the Hartwell recreation area.
13. The widening and upgrading of Shadybrook to accommodate increased traffic volumes.

#### CIRCULATION POLICIES - VEHICULAR

The Design Plan recommends the following traffic circulation improvements to be made within the business district:

- realignment of the intersection offset of Compton Road/Sheehan Road and Vine Street and provide left turn stacking lanes on Vine for north and southbound traffic.

- widen Vine Street to allow north and southbound turn lanes at Hillsdale, and at proposed entrance to the Northern core shopping center.
- widen Vine Street to allow northbound left turn lanes at Shadybrook, and at the proposed entrance points to the new Kroger facility, opposite Glendale and Parkway.
- upgrade and widen Shadybrook from the rear property line of the proposed Kroger site to Vine Street.
- close and abandon Mary Street to allow unified redevelopment of the site.
- improve the existing circulation pattern so as to minimize the impact on the secondary residential street system as shown on the Design Plan.
- reduce the number of curb cuts and independent driveways along Vine Street right-of-way by consolidating parking areas, and eliminating off-street front-in parking.
- minimize or eliminate the visual clutter and confusion of competing public and private signs within the streetscape right-of-way.
- provide solutions to the Parkway and Glendale roadway problems through the utilization of one-way traffic flows and/or the use of cul-de-sacs.

### CIRCULATION POLICIES - PEDESTRIAN

Vine Street is the major arterial highway that carries traffic into and through the business district. The business district in Hartwell is extremely dependent upon, and is oriented exclusively to the automobile. Pedestrian access to the business district is quite limited. Moreover, the neighborhood's residential densities adjacent to the commercial district are not sufficient to support a high level of pedestrian penetration of the district. However, future conditions are expected to be substantially different in the 1980's. It can reasonably be expected that pedestrian travel to and from the NBD will increase considerably in the future, though still below the level of many existing urban-oriented neighborhood business districts. Equal in importance, however, will be the ability of people, regardless of how they arrived at the business district, to be able to circulate freely and conveniently throughout the retail center. The design plan attempts to link the major components of the area's physical retail structure with a pedestrian circulation system in order to maximize the accessibility of the district to its uses. The design plan attempts to create both the climate and the avenues for pedestrian circulation within the focus area.

Improved pedestrian crosswalks are proposed at key Vine Street locations as indicated on the Design Plan. In addition, the Urban Design Plan proposes the following improvements:

-sidewalk material should be used to encourage pleasant, easy walking and should be used in alteration so that they add texture, color, and scale to the ground plane.

-proposed sidewalks between parking entry points should be paved with the same material of the sidewalk, so that the pedestrian zone is emphasized in a continuous manner, to call attention to the automobile driver.

-appropriate street furniture should be utilized to enhance the functional and visual aspects of the NBD. Pedestrian seating, lighting, waste receptacles and information signs should be designed so that they keep with the visual theme and character of the business district. The material of street furniture should be coordinated with their design and location to promote visual cohesiveness.

-street trees should be planted at designated locations and protected by tree grates. Trees should be used selectively to emphasize a visual continuity and rhythm along Vine Street, as well as to indicate pedestrian focal points.

-trees and other plantings should be used for screening and defining parking areas from pedestrian places as well



as parking areas adjacent to the NBD residences. In such cases, evergreens should be used for year round buffering.

#### PARKING

The Hartwell business district is deficient in the total number of off-street spaces needed to sustain a viable and expanded business center. Detailed parking surveys conducted in the business district indicate that the available number of parking spaces at a number of locations are insufficient. Given the zoning standard of one parking space per 250 square feet of commercial floor space, approximately 235 additional spaces are needed for the northern half of the NBD alone. The Urban Design Plan proposes to improve and expand the number of off-street parking spaces within the district toward meeting the design goal of one space per 250 square feet of commercial floor space. The Town Center District has the greatest need for additional parking followed by the Vine Street center's between Sheehan and Galbraith.

The design plan proposes to improve, upgrade, and redesign the existing parking areas within a coordinated design layout for both areas, which would take advantage of existing space that is presently under-utilized. New parking areas are proposed for the entire NBD area.

A second area of improved parking is proposed for the east side of Vine Street between Sheehan and Hillsdale. The parking lots in this

area are to be designed and organized to facilitate access, convenience, and improved circulation relative to the specific redevelopment requirements proposed for the area.

A third parking area improvement program is proposed for the west side of Vine Street between Compton Road and Pfau Street. This area presently has a total of 159 parking spaces. The central and lower part of the area is extremely deficient in parking which has been a major deterrent to the economic viability of the area. New off-street parking is proposed to be developed opposite Ferndale, on the west of Vine Street.

A fourth parking area is planned in conjunction with the new Kroger superstore which is also intended to serve the new Hartwell recreational facility adjacent to the new proposed Kroger parking lot. Other parking areas are expected to be developed in relation to new development activities, envisioned in the proposed negotiated reinvestment areas.

#### URBAN ENVIRONMENTAL QUALITY

Underlying the NBD's negative appearance and physical structures is the lack of a clear identity and image beyond its principal orientation to the automobile. Throughout the NBD there is an evident decline in appearance and neighborhood character. The loose relationship between

buildings and open parking lots adds to the area's low attractiveness and lack of pedestrian amenity.

The NBD lacks continuity in its commercial building fabric throughout the Vine Street commercial corridor. The ad hoc placement of existing buildings in relation to each other, and to the street, creates a non-cohesive, disjointed environment. This is further amplified by the presence of unattractive building facades, colors, materials, signs, etc.

The degree of appearance change to the NBD's will be determined on the type of improvements used, the degree of their intensity and boldness, and their conformance with the guidelines established in the design plan. The major effort of the design program should be to thrust a visual theme into the process of revitalization and development which will underline and unify the incremental private and public improvements throughout the NBD retail environment. The present appearance of the NBD and the rate of its deterioration warrant strong commitments and action aimed toward achieving positive change.

#### Objectives

1. The visual impact in the revitalization of the NBD should consider the major traffic arterial function of Vine Street and the influence that it exerts on the maintenance of an automobile-oriented shopping district. Improvements to the

appearance and environmental quality of the NBD should strive towards counteracting the traffic-related influence through appropriately bold physical and visual change.

2. Building improvements and streetscape changes should strive toward reinforcing the visual appearance of continuity of building form along Vine Street, so that a more cohesive NBD image can emerge, creating a new identity for the area.
3. A unified visual theme should be established for each subarea, and applied throughout the building improvements, streetscape elements, luminaires, signage, etc.
4. Within the visual retail environment, unified efforts should be made in maintaining a harmonious contract in building texture, color, and form, individually for each subarea in order to minimize the linear impact of Vine Street.

#### Guidelines

The following are recommended to serve as guidelines for improving the visual quality and appearance of the Hartwell NBD.

### Storefront and Building Facade Improvements:

1. Original building surfaces should be maintained through restoration and clean-up of facade material.
2. Individual building fronts should be kept visually accessible to the shoppers; and street visual attractiveness should be increased through coordinated building facade treatment, window displays and signage.
3. Entrances of new buildings in the northern core area should relate to the pedestrian retail mall, and should provide for a transition between the exterior and interior space via recessed entrances; where possible, architecturally and graphically defined doorways and display areas, and the use of signs and awnings.
4. Any new building or building improvements should use exterior building materials of the type which will be in harmony with surrounding buildings and the overall accepted visual theme. Where possible, brick and/or other masonry buildings should be retained in their natural state.
5. A compatible color scheme should be utilized for painting within each core area. Utilize relatively dark colors for buildings with volumes and form that need to be de-emphasized.

An approved list of materials and color samples should be developed. Bright and contrasting paint colors should be used to create a sense of vitality.

6. Facade treatment to the upper stories of a building with materials other than the original facing should be avoided.

#### Signs

1. All outdoor advertising signs should be placed parallel to the building facade. They should be designed so that they relate to and enhance the building, its function, scale materials, details, and color.
2. Signs should be consistent and should be visible to pedestrians and legible to motorists.
3. Businesses should be encouraged to use traditional symbols (such as barber pole for a barber shop) or translate the nature of their business into a symbol or logo. The predominant copy of all signs should identify the business on the premises, or its principal produce or service and should, at the same time, promote good graphic design.

4. The number of signs placed on building facades should be limited to the minimum necessary to adequately identify the building's principal function.
5. Window graphics should not cover more than forty (40) percent of the window surface. Window areas should be used for promotion of merchandise (displays).

#### Outdoor Lighting

1. Lighting should be used to create a human scale and reduce glare from widely-spaced high intensity lamps on tall poles. In addition, lighting should be in scale with the overall NBD building height.
2. A uniform design of luminaires should be established according to the NBD visual theme. Light fixtures could be on free-standing poles or mounted on buildings if necessary. The overall lighting level of pedestrian spaces should be determined by considering all lighting sources in the street, sidewalks, and window displays.
3. Lighting should promote a safer and more secure feeling to pedestrians. In parking lots in rear building areas, lighting

should also be used to define secure building and alleyway entry points.

4. A clear hierarchy of luminaires should be established for proper light distribution from pedestrian areas to roadways. High mast luminaires should only be used for roadway lighting.



## IMPLEMENTATION AND PROGRAM SCHEDULE

Implementation of the Hartwell Urban Design Plan as is presented for the entire Neighborhood Business District, will require joint cooperation and coordination between the political jurisdictions of the Cities of Cincinnati, Hamilton County and Springfield Township. This coordination must also include the joint involvement of the private sector as well. The coordinative and economic issues that stand between the local jurisdictions cannot be underestimated. The priorities and capabilities of the aforementioned jurisdictions are quite different, and there is little reason to assume that all the jurisdictions are equally supportive of the Urban Design Plan. Unless there is adequate support within the Hartwell area to implement the proposed design plan, very little can be expected to occur; and the City should not unilaterally take responsibility for its revitalization.

The ultimate success of the urban design plan will fall on the Hartwell Neighborhood and its business community, for it will be up to this interest and community group to lobby effectively for city and county appropriations and involvement in the systematic implementation of the revitalization program.

It should also be noted that much of the proposed redevelopment activities are concentrated along the Hamilton County side of Vine Street, requiring both the County and Springfield Township to realize the potential for economic development and assume major responsibility in the redevelopment of the NBD. While redevelopment could be designed to encompass only that segment of the NBD which lies within the City of Cincinnati, any successful revitalization scheme must recognize that the opposite side

of the street is of critical importance and an integral part of the NBD. Redevelopment which only includes those activities on the City side cannot adequately perform the kind of restructuring which is necessary in the Hartwell NBD. The overriding concern of the design plan has been to find a means of coalescing the existing neighborhood retail activities together into a well-defined and vital shopping core area. The best means of accomplishing this objective is to merge the two sides of Vine Street into a unified commercial district.

#### PHASING

The first phase of the development program will need to concentrate on organizing the necessary support facilities appropriate to carry out a long-term joint development process. The second phase should emphasize the development of the Hartwell public recreational facility complex and the proposed commercial development on the adjoining site. The third phase of the development program should emphasize a common streetscape program for the northern section of the NBD. The final phase of development should renew the northern town center focus area. Early stages of implementation should emphasize projects that are highly visible and which encourage public and private participation.

With respect to the evolution of the Hartwell Urban Design Plan, the development process for the entire NBD area should be envisioned as a set of events, of public and private decisions and commitments in response to the emerging economic development vitality. Tables 1 and 2 list the implementation events and actions with respect to costs, responsibility for execution, and timing.

**TABLE 1: HARTWELL NBD URBAN DESIGN IMPLEMENTATION PROGRAM  
IMPLEMENTATION EVENTS AND ACTIONS**

Events and Actions	Cost	Agent
● Creation of a Hartwell Business Association		
● Adoption of the Final Design Plan by City Council		
● Organization of Hartwell NBD Task Force		
● Creation and initiation of an NBD "Clean-Up" and "Fix-Up" campaign		
● Initiation of the redevelopment and construction of the Hartwell Recreation Center complex		
● Initiation of the Kroger Superstore development and attendant roadway improvements		
● Initiation of the streetscape improvement program for the central and northern core areas	205,100	Private
	172,000	Public
● Street intersection improvement at Compton-Sheehan	95,545	Public
● Curb and gutter improvement on Locust Street	9,000	County
● Acquisition and clearance of 8343-49 Vine Street	55,700	CIC/County
● Initiation of Building Rehabilitation Program	215,000	Private
● Acquisition, relocation and clearance of #14 and #30 Compton Road	100,200	CIC/County
● Closure of Mary Street (Relocation of water lines)	35,000	CIC/County
● Creation of NBD parking at #30 Compton Road and 8343-49 Vine	20,312	CIC
● Expansion of Big Melon Complex acquisition of three parcels in the northeast corner of Vine Street and Sheehan Streets	278,500	Private

TABLE 1: HARTWELL NBD URBAN DESIGN IMPLEMENTATION PROGRAM (CONT.)  
 IMPLEMENTATION EVENTS AND ACTIONS

Events and Actions	Cost	Agent
● Acquisition of parcel segments at 8401, 8415, and 8419 Vine Street	79,800	CIC
● Site preparation	1,200	CIC
● Redevelopment of the Big Melon Complex		Private
● Construction of new commercial space at #14 Compton Road	265,000	Private
● Construction of the pedestrian interface between existing establishments and the new construction	125,000	Private
● Completion of NBD parking lot development at 8401-8419 Vine Street	36,000	CIC
● Development of public amenity space along western side of Vine Street	60,000	County/ Private

**TABLE 2: HARTWELL NBD URBAN DESIGN IMPLEMENTATION PROGRAM  
PHASING OF EVENTS AND ACTIONS**

	'81	'82	'83	'84	'85	'86	'87	'88
● Creation of a Hartwell Business Association	●							
● Adoption of the Final Design Plan by City Council	●							
● Organization of Hartwell NBD Task Force	●							
● Creation and initiation of an NBD "Clean-Up" and "Fix-Up" campaign	●							
● Initiation of the redevelopment and construction of the Hartwell Recreation Center complex	●							
● Initiation of the Kroger Superstore development and attendant roadway improvements	—							
● Initiation of the streetscape improvement program for the central and northern core areas	—	—	—	—				
● Street improvement at the intersection of Compton and Vine		—						
● Curb and gutter improvement on Locust Street		—	—					
● Acquisition and clearance of 8343-49 Vine Street		—						
● Initiation of Building Rehabilitation Program		—	—	—	—			

TABLE 2: HARTWELL NBD URBAN DESIGN IMPLEMENTATION PROGRAM (CONT.)  
 PHASING OF EVENTS AND ACTIONS

	'81	'82	'83	'84	'85	'86	'87	'88
● Acquisition, relocation and clearance of #14 and #30 Compton Road			—————					
● Closure of Mary Street		●						
● Creation of NBD parking at #30 Compton Road and at 8343-49 Vine			—————					
● Expansion of Big Melon Complex acquisition of three parcels in the north-east corner of Vine Street and Sheehan Streets			—————					
● Acquisition of parcel segments at 8401, 8415, and 8419 Vine Street					—————			
● Site preparation						●		
● Redevelopment of the Big Melon Complex						—————		
● Construction of new commercial space at #14 Compton Road							—————	
● Construction of the pedestrian interface between existing establishments and the new construction						—————		
● Completion of NBD parking lot development at 8401-8419 Vine Street						—————		
● Development of public amenity space along western side of Vine Street						●		

## HARTWELL ZONING

It is recommended that the implementation of the Urban Design Plan for the Cincinnati portion of the Hartwell Neighborhood Business District Area include the creation of an Interim Development Control (IDC) District, in order to protect the integrity of the plan and to prevent any new uses or development that would be inconsistent with the Urban Design Plan. The Interim Development Control District would in effect create an overlay district on top of the Urban Design Plan for a period of twelve (12) months, during which time an Environmental Quality District amendment, or alternative zoning measure, could be instituted for the Neighborhood Business District consistent with the design principles and guidelines promulgated in the NBD Urban Design Plan.

The Urban Design Plan further proposes, as recommended on pages 24 through 26, to downzone from B-4 to B-2 a section of the east side of the Vine Street commercial district that lies between Glendale Avenue south to the projected centerline of the Ridgeway-Vine Street intersection.

## URBAN DESIGN REGULATORY REQUIREMENTS

It is recommended that the implementation of the Urban Design Plan for the Cincinnati portion of the Hartwell Neighborhood Business District Focus Area include the creation of an Interim Development Control (IDC) District, in order to protect the integrity of the plan and to prevent any new uses or development that would be inconsistent with the Urban Design Plan. The Interim Development Control District would in effect create an overlay district on top of the Urban Design Plan for a period of twelve (12) months, during which time an Environmental Quality District amendment, or alternative zoning measure, could be instituted for the Neighborhood Business District consistent with the design principles and guidelines promulgated in the NBD Urban Design Plan.

It is further recommended that the City side of the Southern core area south of Jake Sweeney to the proposed NBD boundary, be down-zoned from B-4 to B-2 in conformity with the proposed development policies of general commercial; and that both the City and County jurisdictions establish for their respective territory a special NBD development district zone, which would specify the type, mix and intensity of land uses permitted in each core area. The plan proposes that the County side of Vine Street between Shadybrook and Ridgeway opposite the proposed Kroger facility be rezoned from Residential to "EE" Planned Business District.



## LEGAL BASIS FOR PROPERTY ACQUISITION

Under Chapter 725 of the Cincinnati Municipal Code, it was found that "blighted, deteriorating, and deteriorated areas" exist within the City which "contribute to the spread of disease and crime, . . . ; constitute an economic and social liability; and impair . . . the sound growth of the community". It was also found that this blight and deterioration could not be controlled by private enterprise alone. In order to remedy this situation Chapter 725 authorized the City to expend funds to eliminate blight and deterioration and -- towards this end -- to acquire private property.

In order to expend funds for urban renewal, the City must first prepare an urban renewal plan which defines the area which is blighted or deteriorating, states the reasons for defining the areas as blighted or deteriorating, and recommends a certain course of action to redevelop or rehabilitate the area. When City Council approves the plan, thereby declaring the subject area to be an "Urban Renewal Area", the City administration is formally authorized to carry out the activities recommended in the plan.

Under Chapter 725 of the Cincinnati Municipal Code, an Urban Renewal Area "shall mean a blighted or deteriorating area which is appropriate for redevelopment or rehabilitation as defined in paragraph (a) of Section 725 - 1-U". The City of Cincinnati, for the purposes of this

particular plan, therefore, declares that the Hartwell Business District, Focus Area, more particularly defined in Boundary Description of the Urban Design Area is an Urban Renewal Area. Within the Hartwell defined Neighborhood Business District there exist blighted areas in which a majority of the structures are detrimental to the public health, safety, morals, and general welfare, by reason of age, obsolescence, dilapidation, overcrowding, faulty arrangement, mixture of incompatible land uses, a lack of ventilation or sanitary facilities or any combination of these factors, or there exist deteriorating areas which because of incompatible land uses, non-conforming uses, lack of adequate parking facilities, faulty street arrangement, inadequate community facilities, increased density of population without commensurate increase in new residential buildings and community facilities, high turnover in residential or commercial occupancy, lack of maintenance and repair of buildings, or any combination thereof are detrimental to the public health, safety, morals, and general welfare, and which will deteriorate, or are in danger of deteriorating, into blighted areas. Through the adoption of this Urban Renewal Plan by City Council, the City Manager is authorized to acquire any property in the area defined in the Urban Design Area, the acquisition of which is necessary in carrying out the Urban Renewal Plan.

Further, the Hartwell Neighborhood Business District Urban (Urban Renewal) Plan conforms to the Master Plan of the development of the City. The City has established a feasible method for the relocation of any families, individuals or businesses that shall be displaced from the area by any Federally funded public development action.

## HARTWELL NBD BOUNDARY DESCRIPTION (MUNICIPAL PORTION ONLY)

Beginning at a point, said point being the Cincinnati Corporation line, intersected by the intersection of Vine Street and Ridgeway Road; thence, moving northwardly along said municipal corporation line, and thence, westwardly along said corporation line to a point, said point being the corporation line intersected by the west parcel line of Hamilton County Auditor's Parcels 244-86-53; thence, moving northwardly along the west property line of said parcel and continuing northwardly along the west parcel line of Hamilton County Auditor's Parcel 244-86-54 to a point, said point being the centerline of West Galbraith Road intersected by the west property line of said parcel; thence, moving eastwardly to a point, said point being the intersection of the centerline of Pfau Street and Vine Street; thence, moving northwardly along the corporation line of Vine Street to a point, said point being the north parcel line of Hamilton County Auditor's Parcel 245-3-1; thence, moving eastwardly along the north parcel line of said parcel to the northeast corner of said parcel; thence, moving southwardly along the east property of Hamilton County Auditor's Parcels 245-3-1, 245-3-2, and 245-3-3 to a point, said point being the centerline of Hillsdale Avenue and the east parcel line of Hamilton County Auditor's Parcel 245-3-133; thence, southwardly along the east parcel line of said parcel and continuing southwardly along the east property line of Hamilton County Auditor's Parcels 245-3-28, 245-3-29, 245-3-30, 245-3-31, and 245-3-134 to a point, said point being the centerline of Herford Avenue; thence,

thence, moving southwardly from said line intersected by the east parcel line of Hamilton County Auditor's Parcel 245-3-139, and continuing southwardly along the east property lines of parcels 245-3-139, 245-3-81, 245-3-82, 245-3-143, 245-3-140, and 245-3-136 to a point, said point being the centerline of Sheehan Avenue intersected by the east property line of Hamilton County Auditor's Parcel 245-6-153; thence, southwardly along the east property line of Hamilton County Auditor's Parcels 245-6-145, 245-6-141, 245-6-67, 245-6-92, 245-6-93, and 245-6-94 to a point, said point being the centerline of Ferndale Street; thence, eastwardly along the centerline of said street to a point, said point being the centerline of Ferndale Street intersected by the east property line of Hamilton County Auditor's Parcel 245-6-34; thence, moving southwardly along the east property line of Hamilton County Auditor's Parcels 245-6-34 and 245-6-5 to a point, said point being the centerline of East Galbraith Road intersected by the east property line of Hamilton County Auditor's Parcel 244-5-5; thence, moving southwardly along the east property line of Hamilton County Auditor's Parcels 244-5-5 and 244-5-17 to a point, said point being the centerline of Glendale Avenue; thence, moving southwardly along the west property line of Hamilton County Auditor's Parcels 244-5-44 and 244-5-60 to a point, said point being the centerline of Parkway Street; thence, moving westwardly along to a point, said point being the centerline of said street intersected by the east property line of Hamilton County Auditor's Parcel 244-4-3; thence, moving south-

wardly along said parcel line and continuing southwardly along the east property lines of Hamilton County Auditor's Parcels 244-4-7, 244-4-8, and 244-4-9 to a point, said point being the centerline of Hartwell Court (St.), and continuing southwardly along the west property line of Hamilton County Auditor's Parcel 244-4-61 to the southwest corner of said parcel; thence, eastwardly along the adjoining northern property line of Hamilton County Auditor's Parcel 244-4-4; and thence, southwardly along the eastern parcel line of said parcel to the southeastern corner of said parcel, thence, moving westwardly along the northern parcel line of Hamilton County Auditor's Parcel 244-4-24 to a point, said point being the Cincinnati Corporation line, intersected by said parcel line, and the place of beginning.